

**APG** | **Educational Projects**  
CAPABILITY STATEMENT  
ARCHITECTURE & PLANNING GROUP



INNOVATE  
SUSTAINABLE  
**BUILT**  
ENVIRONMENT



## Introduction

Founded in Egypt in the late sixties, and with active presence in the UAE since 1973, APG is a leading multi-disciplinary A/E firm that is fully committed to the construction industry, providing a comprehensive suite of services ranging from Master planning, Architecture, Interior design, through to Civil & Structure and MEP Engineering. Strategically located in the MENA region, APG operates through eight offices in Dubai, Abu Dhabi, Al-Ain, Doha, Riyadh, Cairo, Alexandria, and Khartoum, with overall workforce of more than 400 highly dedicated subject matter experts.

APG's main differentiator is in mastering the business process; APG considers itself a strategic partner to its clients, specifically at the very early stages of any given project. Our clients highly value APG's support in building up stringent and valid alternative business cases for their projects & investments, and our ability to visualize their visions and ideas and experiment its feasibility. This strategy is key to client loyalty and trust, and has been recognized by the high rate of repeat business and referrals. Our formula of success is not only limited to that, but also extends to our ability to collaborate with many international firms in delivering numerous high profile projects, reflected in our diverse and rich portfolio. Another differentiator is excellence in design achieved by responsibly shaping the built environment through architecture that, not only maps the character of the place, but is also inspiring, stimulating and blends the built realm with natural surroundings. APG's ability to provide one-stop development integrations, ranging from architectural design & planning through to interior design and engineering, along with our extensive 40+ local UAE experience, is another key to the firm's success.

APG is currently leading a number of diverse high profile projects ranging from hi-rise mixed use buildings, to hospitality, residential, commercial, educational, and governmental buildings along with a huge portfolio of mosques. Our clients, ranging from public to private sector organizations & developers, have come to trust the firm's group of experienced specialists, who consistently deliver solutions that encompass knowledge, insights, technology, collaboration, reliability, and integrity. This is not only limited to their design team, but also extends to their site supervision group of professionals.

## APG Vision

Innovative Sustainable Built Environment.

## APG Mission

Providing the utmost quality of services with the most innovative Architectural and Engineering Solutions to our clients through professional motivated employees. We believe in setting the highest standards and the best practices of industry through our commitment to Environmental, Economic, Social and Cultural Factors.

## APG Values

With all the efforts to achieve our strategic vision and mission at all organization levels, we refer to our shared values that remain the prime reference at all times.

### *Exceeding Clients Expectations*

We commit to utilize our capabilities, provide optimal services and modern technology to meet our top priority ultimate goal.

### *Innovation & Creativity*

We are committed to applying advanced research and development techniques to create solutions that add value to the Built Environment.

### *Talent Engagement*

We are continuously building a culture based on team spirit, motivation and talent management to our most valuable asset.

### *Excellence and Quality*

We strive to provide the highest quality standard of services with emphasis on efficiency & effectiveness

## Quality Policy

The ability to maintain quality in APG is validated by attaining the ISO 9001:2008 certification. We believe in continuous development of our services and in continuous education for our team in order to compete in today's knowledge economy.



## POLICE & TRAFFIC INSTITUTE

Abu Dhabi, UAE

The complex building is comprised of [Ground + 3 floors + Roof] with a total area of 15700 m2 and maximum height of 19.25 m. the building is designed to function for three activities; administration, education, and accommodation, each having some support spaces attached to them. Following is a brief description of the building details and functions areas:

- 1 Administration building
- 2 Educational building
- 3 Accommodation building
- 4 Restaurant building
- 5 Traffic institute building

<b>Client</b>	: Police projects Committee
<b>BUA m2</b>	: 15,700 M2
<b>Completion</b>	: Expected 2020
<b>Cost (AED)</b>	: 35,000,000
<b>APG role</b>	: Lead Consultant, Concept Design, Detailed Design, Engineering Design Services, Interior Design, Site Supervision & AOR Services







## MUSIC SECTION

Abu Dhabi, UAE

### PROJECT DETAILS

Client	: Police projects Committee
BUA m2	: 9,500 M2
Completion	: Expected 2020
Cost (AED)	: 25,700,000.00
APG role	: Lead Consultant, Concept Design, Detailed Design, Engineering Design Services, Interior Design, Site Supervision & AOR Services

A host of all the training activities of the National Music Cadets of Abu Dhabi Police. Desired to meet Estidama standards, on the one hand, the Design is a manipulation of projecting & recessing simple blocks which affects the façade with strong articulation. On the other hand, the manipulation in height creates a visual “musicality” that reflects the function of the project.

### Components:

- Administration & Multipurpose hall building.
- Educational building
- Supporting services building
- Accommodation & Restaurant building











## POLICE SCHOOL PHASE 1&2

AI-AIN, UAE

### PROJECT DETAILS

Client	: Police Projects Committee
BUA m2	: 650,000 M2
Completion	: 2016 Phase 1 Phase 2 expected 2020
Cost (AED)	: 370,000,000.00
APG role	: Lead Consultant, Concept Design, Detailed Design, Engineering Design Services, Interior Design, and Site Supervision & AOR Services

Projects is divided into two phases:

#### Phase one consists of following buildings:

1. Male education building
2. Female education building
3. Female accommodation building
4. Male accommodation buildings (4)
5. Female restaurant
6. Main administration building

#### Phase two consists of the following buildings:

1. Officers' Club
2. Theatre,
3. Music Training Building
4. Indoor Sports Hall
5. Shooting Range
6. Clinic
7. Restaurant
8. Trainers' Accommodation
9. Mosque
10. Male Parade Yard





















# NEW INTERNATIONAL SCHOOL (Operated by: Choueifat)

RUWAIS - ABU DHABI, UAE

## PROJECT DETAILS

Client : ADNOC  
BUA m2 : 39,000 M2  
Completion : Phase 1 Expected 2014  
Phase 2 Expected 2015  
Cost (AED) : 202,000,000.00  
APG role : Concept Design, Detailed Design, Engineering Design Services,  
Interior Design & AOR services.

Hosting classes from Kindergarten to Grade 12, the New International School aims to fulfil the Educational needs of the city's population growth for the upcoming 50 years.

### Components:

#### Phase 1

- Kinder Garten & Primary School
- Pool Block & Facilities
- Outdoor Activity Area
- Gate & Security
- Karting Field

#### Phase 2

- Secondary School
- Sports Hall (Olympic Swimming Pool + Gym +

#### Multipurpose Playground)

- Multipurpose Hall & Cafeteria
- Mosque
- Gate & Security
- Football Field & Bleacher
- Libraries

#### Administration Building















# AL EKHLAS PRIVATE SCHOOL

AL-SHAMKHA, ABU DHABI, UAE

## PROJECT DETAILS

Client	: Al Ekhlass Private School
BUA m2	: 30,000 M2.
Completion	: Expected 2018
Cost (AED)	: 93,000,000.00
APG role	: Lead Consultant, Concept Design, Detailed Design, Engineering Design Services, Interior Design, Site Supervision & AOR Services

The client is intending to construct a school, to host classes from Kindergarten to Grade 12, with the aim of fulfilling the Educational needs of the city's population growth. The colorful Pastel shades tackle the students' senses & allow them to enjoy their daily learning experience.



























# NEW ASIAN SCHOOL

AL-RUWAIS, ABU DHABI, UAE

## PROJECT DETAILS

Client : ADNOC  
BUA m2 : 47,000 M2.  
Completion : Expected 2019  
Cost (AED) : 140,000,000.00  
APG role : Lead Consultant, Concept Design, Detailed Design, Engineering Design Services, Interior Design

The client is intending to construct a school, accommodating 3000 students from Kindergarten to Grade 12, with the aim of fulfilling the Educational needs of the city's population growth.

### Components:

- KG/ Primary school + Facilities (pool, indoor sports hall, playing areas, etc.)
- Boys school + Facilities (Sports Hall, Indoor Swimming Pool, Multipurpose hall & Cafeteria Building, Mosque, etc.)
- Girls school (G6:G12) + Facilities (Sports Hall, Indoor Swimming Pool, Multipurpose hall & Cafeteria Building, etc.)
- Shaded & exposed car parking, Buses parking & drop off points, Service Buildings, Outdoor Playing Courts, Outdoor Shaded Playgrounds











Multi-purpose Hall





Girls' School













# MALE & FEMALE HIGH SCHOOL

Al Gayathi, Abu Dhabi, UAE

## PROJECT DETAILS

Client : ADNOC  
BUA m2 : 43,920 M2.  
Completion: Expected 2020  
Cost (AED) : 220,000,000.00  
APG role : Lead Consultant, Concept Design Development,  
Detailed Design, Engineering Design Services,

Two schools that accommodate Male & Female schools starting from grade 6 to 12. Respecting the radial plot form, the Design is simple & functional in order to represent the Educational purpose it hosts. Inspiring gender equality of rights for a proper Education & learning environment, the same Design is mirrored along the main Entrance axis that leads to the sports Facilities.

## Components:

### School Building

- Main Building (classrooms, labs, administration, etc.)
- Extension Building + Facilities (indoor Swimming pool, tennis, sports hall & outdoor handball, football, basketball pitches & playgrounds)

### Auditorium

- Capacity of 360 seats
- Maintenance workshops
- Books & uniform stores

### Parking



Auditorium



Sports Hall



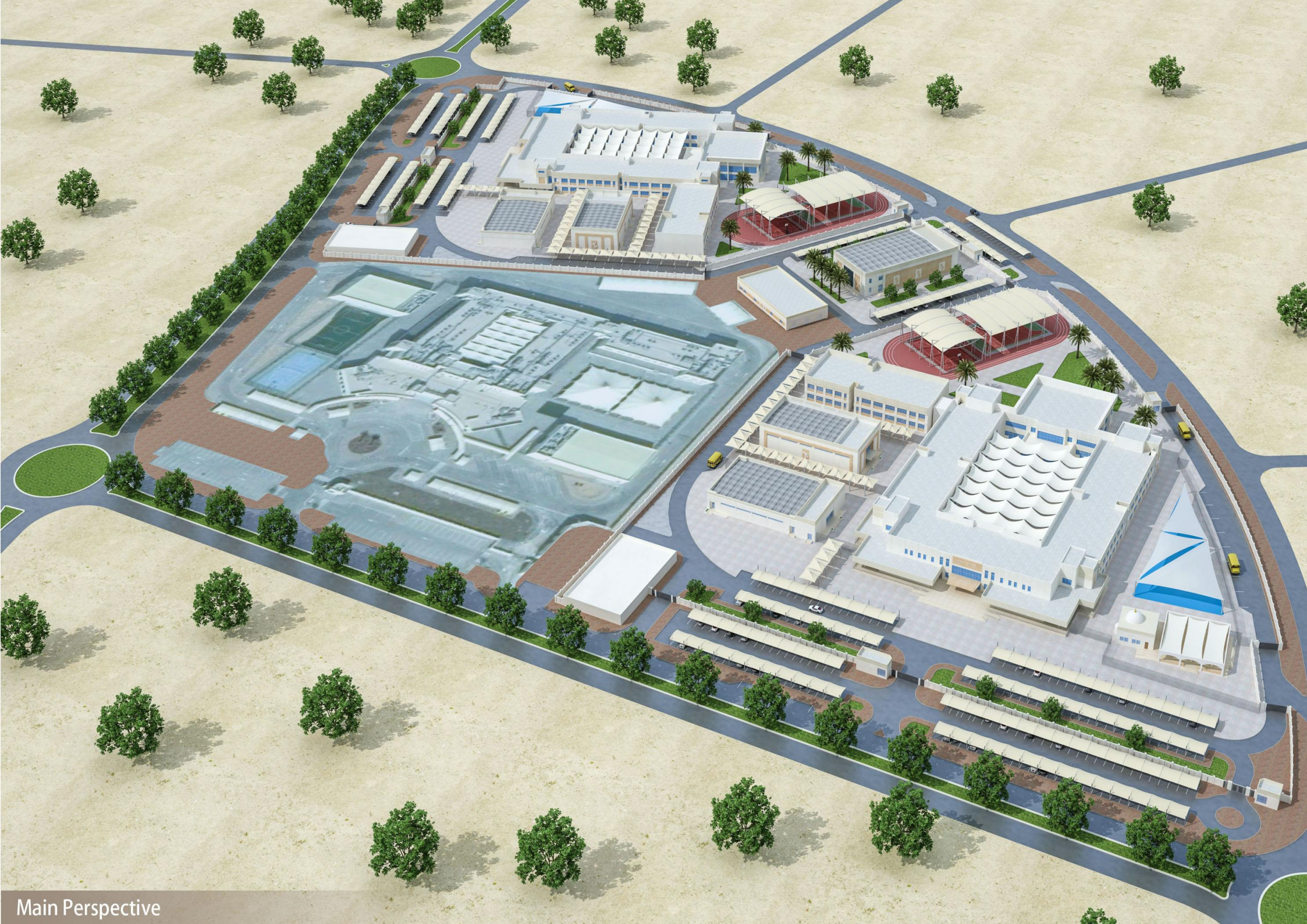

Main Perspective









Females' School





## SCHOOL FOR ABU DHABI WOMEN SOCIETY

AL-AIN, UAE

Consisting of 4 buildings: Kindergarten, Secondary School, Administration & Multi-purpose Hall, as the Lead Consultant, our Design combined Landscaped courtyards within the Educational blocks in order to create a proper learning environment for students.

### Components:

- Kindergarten
- Secondary School
- Administration Building & Multipurpose Hall

### PROJECT DETAILS

<b>Client</b>	: Abu Dhabi Women Society
<b>BUA m2</b>	: 8,500 M2.
<b>Completion</b>	: 2005
<b>Cost (AED)</b>	: 55,000,000.00
<b>APG role</b>	: Lead Consultant, Concept Design, Detailed Design, Engineering Design Services, Interior Design, Site Supervision & AOR Services

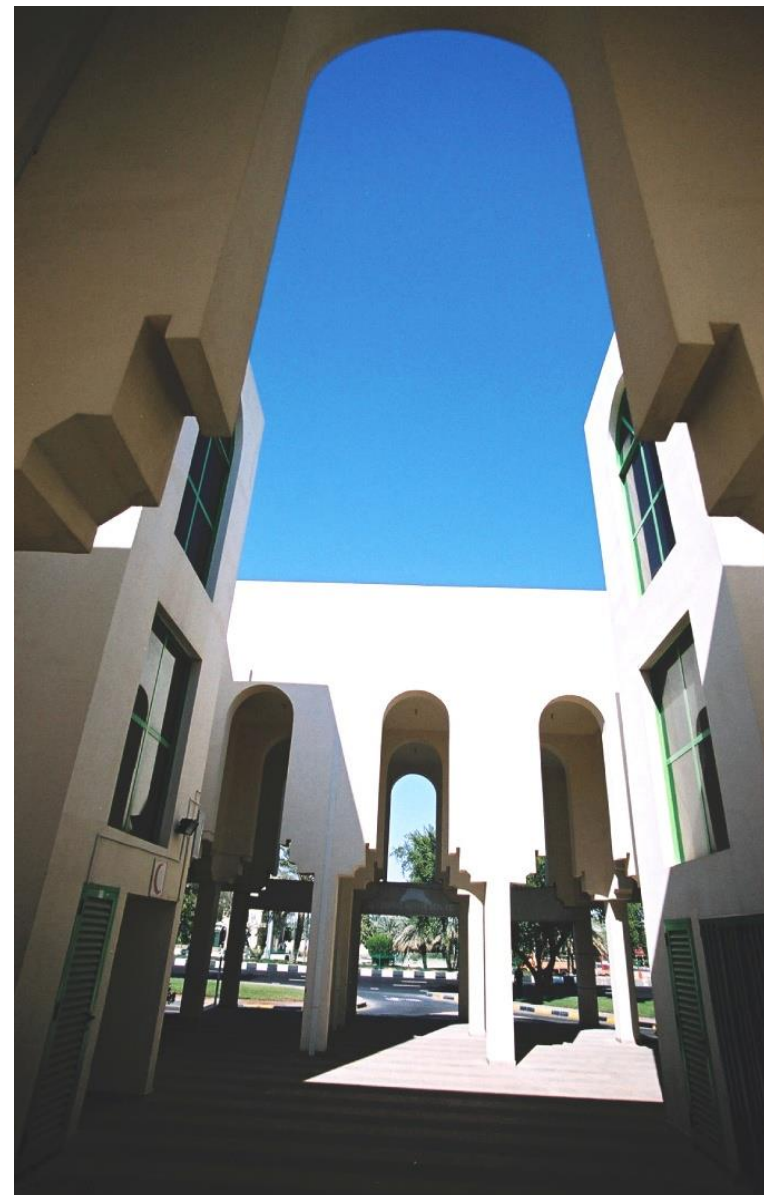









# WOMEN UNIVERSITY

AJMAN, UAE

A Design that presents the most beautiful features of Neo- Islamic Architecture that is fitted to serve the Educational function of the project With an oriental huge Arched Entrances that Represent the Importance of the University as a gate of Science For all the students.

## PROJECT DETAILS

Client : Private  
BUA m2 : N/A  
Completion : 2001  
APG role : Proposal











## Nursery of Ministry of Presidential Affair

Abu Dhabi, UAE

Client : Ministry of Presidential Affairs  
BUA m2 ::: 2500 m2  
APG role : Proposal

A small Nursery located on the water Front of Abu Dhabi in the Ministry of Presidential Affair Zone for the employees there to leave their children in a good care within the working Hours.









**UAE, Abu Dhabi**

P.O.Box 2833  
Tel. +971 2 6333 022  
Fax. +971 2 6332 883  
Email: abudhabi@apgarch.com

**UAE, Dubai**

P.O.Box 34471  
Tel. +971 4 3326 115  
Fax. +971 4 3326 145  
Email: dubai@apgarch.com

**UAE, Al Ain**

P.O.Box 16001  
Tel. +971 3 7650 293  
Fax. +971 3 7518 069  
Email: alain@apgarch.com

**KSA, Riyadh**

Mail13321-6118  
Tel. +966 11 2033319  
Fax. +966 11 2032945  
Email: riyadh@apgarch.com

**KSA, Jeddah**

T: +966 1 261 22344  
F: +966 1 261 24244  
Email: saudi@apgarch.com

**Egypt, Cairo**

P.O.Box 11341  
Tel. +20 2 2453 6760  
Fax. +20 2 2259 2057  
Email: cairo@apgarch.com

**Egypt, Alexandria**

P.O.Box 2242  
Tel. +20 3 582 4451  
Fax. +20 3 582 7276  
Email: alexandria@apgarch.com

**Qatar, Doha**

P.O.Box 47673  
Tel. +974 4431 1235  
Fax. +974 4443 6762  
Email: doha@apgarch.com

**Sudan, Khartoum**

P.O.Box 10490  
Tel. +249 18324 3781  
Fax. +249 18324 3781  
Email: sudan@apgarch.com

[www.apgarch.com](http://www.apgarch.com)